

WILBRAHAM, MA
FOR LEASE – 2030 BOSTON ROAD – 1,200sf - 6,000sf AVAILABLE



1,200 – 6,000+/- sf subdividable - end cap or in-line space available.

Join proposed Delaney's Market on Route 20 at a new retail redevelopment with signal light access.



Demographics	1 Miles	3 Miles	5 Miles
Population	7,397	49,704	110,094
Households	3,270	20,418	41,660
Avg HH Inc	\$61,830	\$70,456	\$72,112
Daytime Pop	4,772	16,666	33,365

8,460sf building on 0.83ac

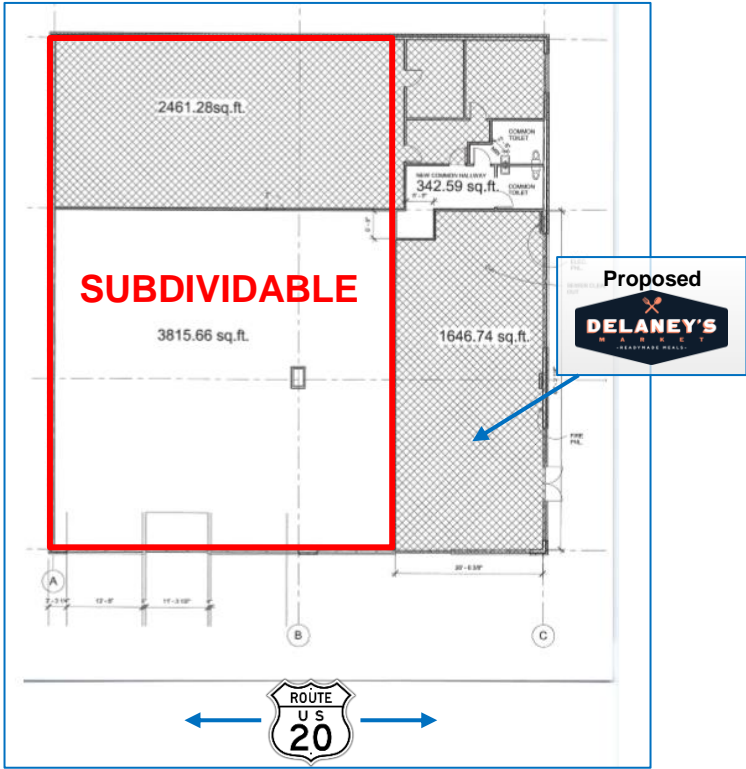

Contact:
John Benoit, 413.567.2900, john@VantagePointRetail.com
734 Bliss Road, Suite 1, Longmeadow MA 01106

No representations, express or implied, are made as to the accuracy of the information contained herein. Property is offered subject to prior sale, lease, or withdrawal, without notice.